

PRODUCT SELECTION



WATER QUALITY MONITORING MADE EASY

Real Tech offers a wide array of water quality monitoring solutions

FIELD METERS

Real Tech's portable field meters allow for quick analysis in the field anywhere, anytime.

ANALYZERS

Real Tech's analyzers have built-in controllers and are ready to go.

SENSORS

Real Tech provides both bypass and probe style form factors. Multiple Real Tech sensors can be connected to a preferred controller to create the water quality monitoring package that best meets our clients needs and budget.

PARAMETER	FIELD METERS	ANALYZERS	BYPASS SENSORS	PROBE SENSORS
Ammonium			●	●
Benzene			●	●
BOD/COD	●		●	●
BTEX			●	●
Chromium VI			●	●
Colour	●	●	●	●
Conductivity			●	●
DO			●	●
Free Chlorine		●	●	
Hydrocarbons (Oil in Water)			●	●
Hydrogen Peroxide			●	●
Hydrogen Sulfide			●	●
Nitrate			●	●
Nitrite		●	●	●
Ozone			●	●
Permanganate			●	●
pH/ORP			●	●
Surfactants			●	●
THM / HAA			●	
TOC/DOC	●		●	●
TSS			●	●
Turbidity			●	●
UV254	●	●	●	●
UVT	●	●	●	●

● Available

● Dedicated multiple UV/VIS LED Sensor

Easily Build the Configuration That's Right For You

Real Tech's modular platform allows you to build the right solution for your needs and budget.

1



SELECT YOUR SENSORS

Select from a wide array of real-time water quality monitoring sensors to ensure you can gain up to the minute insights on the parameters and compounds that are most important to you.

2



CHOOSE YOUR CONTROLLER

Choose from two controller options offering a two different operator interfaces with variety of I/O options.

3



ADD ON ACCESSORIES

Select from several different sample conditioning, and cleaning options to improve performance and lower maintenance.

4

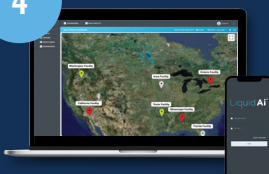

COMPLETE WITH LIQUID AI SERVICES

Add on our Liquid AI data services including remote monitoring and calibration update services to bring valuable insights to your data.

Important criteria to help make your decision easy and simple:

PARAMETER SELECTION:

What do you want to monitor for?

- Select your sensors based on desired parameters needed

RANGE REQUIREMENTS:

What detection range do you need for each parameter selected?

- This will narrow down the sensors measurement path length (and therefore sensor model) needed
- If range requirements require dilution system this will narrow your sensor selection to bypass style sensors only to accommodate the use of the dilution system accessory

WATER CONDITIONS:

Is the application open channel / non-pressurized or pressurized?

- This helps to determine form factor with submersible probes more ideal for open channel applications and bypass style sensors for pressurized applications

Is there intermittent flow?

- Probes are ideal for applications with intermittent flow, however bypass sensors can be used with the Dual Feed accessory provided a clean water source is located at the installation location

PHYSICAL LOCATION CHECK:

Are there physical constraints for installation location, or freezing conditions for outdoor installation?

- Probe sensors can operate in outdoor freezing weather conditions. If space constraints exist for installing probe in open channel, a bypass sensor can be selected with a pump system accessory

Configuration Examples:

1

WATER CONDITIONS

- Pressurized

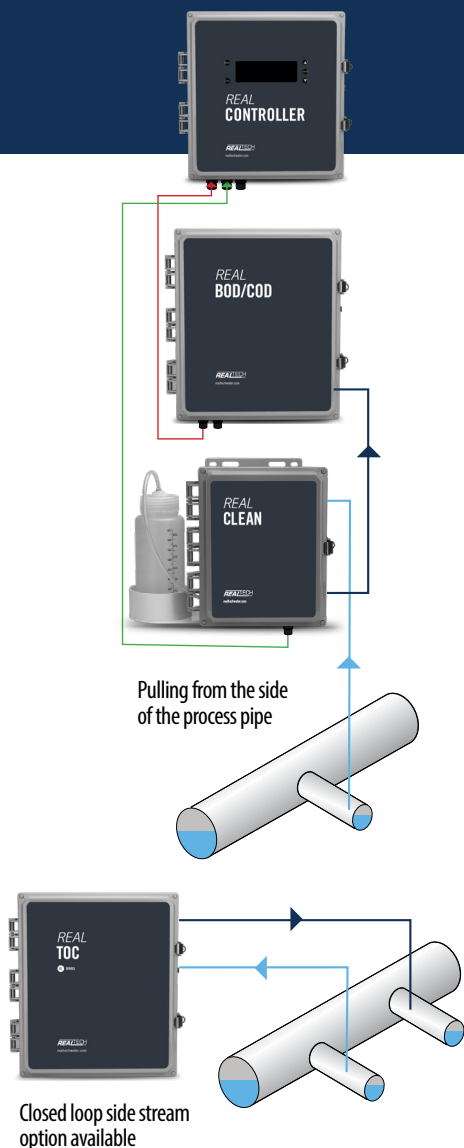

CONTROLLER

- Real Controller (upgrade to Pro* version available)

SENSOR FORM FACTOR

- Bypass sensors

ACCESSORIES

- Real Clean

ADD-ON OPTIONS*

- Dual Feed (used to monitor two sample streams or used for intermittent flow installations, note this requires clean water at monitoring location)
- Liquid Ai Data Services

*Not shown in illustration

2

WATER CONDITIONS

- Open-channel / Non-pressurized

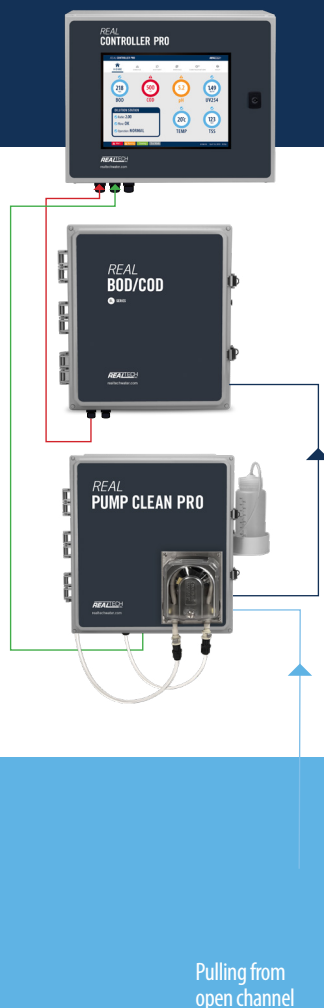

CONTROLLER

- Real Controller (upgrade to Pro* version available)

SENSOR FORM FACTOR

- Bypass sensors

ACCESSORIES

- Pump Clean Pro (high solids) or
- Pump Clean* (for low solids)

ADD-ON OPTIONS*

- Compressed Air System (when no compressor air is onsite)
- Liquid Ai Data Services

3

WATER CONDITIONS

- Open-channel / Non-pressurized

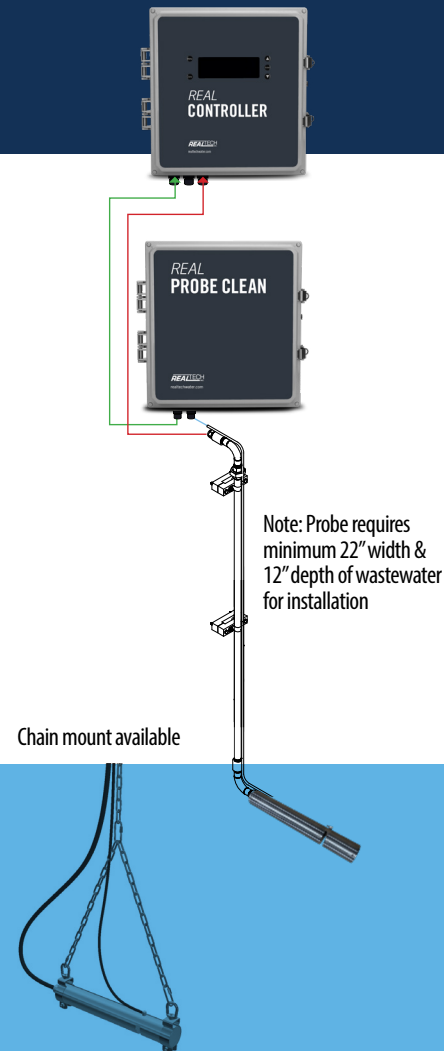

CONTROLLER

- Real Controller (upgrade to Pro* version available)

SENSOR FORM FACTOR

- Probe sensors

ACCESSORIES

- Probe Clean

ADD-ON OPTIONS*

- Compressed Air System (when no compressor air is onsite)
- Liquid Ai Data Services



EVERY MINUTE OF
EVERY DAY

WHERE THERE IS WATER
WE ARE THERE

1000's of clients in over 50 countries
trust and rely on Real Tech solutions to
meet their water quality monitoring needs.

Discover more about our products today:
realtechwater.com/products

Real Tech Inc.

1150 Champlain Court,
Whitby, Ontario L1N 6K9 Canada
TF: 1.877.779.2888 T: 1.905.665.6888
info@realtechwater.com

REALTECH
INC.